

Property:



Land Description:

- Residential area
- Back-land, tarred vehicular road, flat topography, regular shape bounded by wire fencing
- Free from encumbrances and charges
- Vacant possession

Situation of Property:

- The Site is found along a common road at Melle Jeanne, Goodlands.
- It lies along a tarred common cul de sac vehicular access, off Plateau Road, at a distance of approximately 135 metres from "Kanhya Govt School"

Title Deed:

Registered in T.V. LS 27 No.8716

Land Area:

460.24m² or 10.90 perches

Service on site:

Water, electricity and telephone

Site Location Plan of subject property:

See Next Page

Site location plan of Subject Property:

[Signature]
Ravin Topsy

Arpenteur juré.

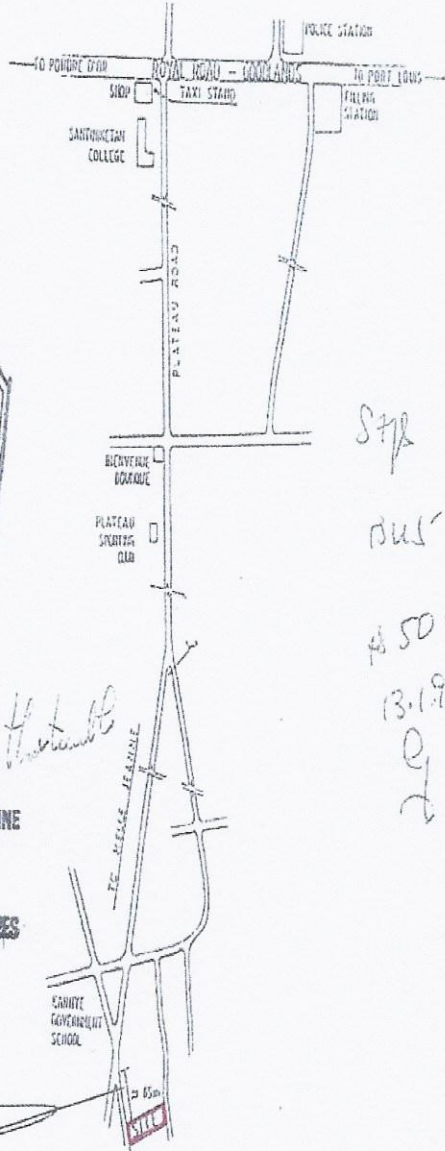
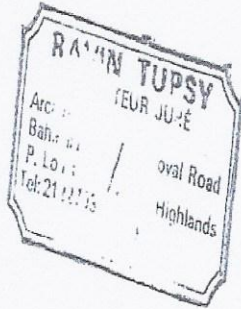

STP
bus
450
13192
2

REGISTERED AT MAURITIUS ON THE
LAY OF *three* ONE THOUSAND NINE
HUNDRED AND NINETY *two*
REG. NO. *13192* RECEIVED RUPIES
AT FIXED DUTY + STAMPS.

[Signature]

LOCATION PLAN

